

## SUN BEDSIDE CRIB



**IMPORTANT  
RETAIN FOR FUTURE REFERENCE  
READ CAREFULLY**

The illustrations in these instructions are to be used as a guide only  
Conforms to BS EN 1130:1997  
Made in Latvia



## SAFETY INSTRUCTIONS

Your child's safety is your responsibility.

Follow the manufacturer's assembly instructions in detail to ensure the safety features of the crib are not compromised.

Remove any tools or excess parts including plastic packaging from the cradle vicinity after its assembly.

Any padding and cushioning materials, including the mattress, need to be sufficiently firm to preclude conforming to the contours of the infant's face.

Do not position the infant face-down into the mattress.

Ensure that proper ventilation is maintained in and around the crib by limiting bed clothes, extra pillows or toys.

Ensure the crib is placed at a reasonable distance from curtains, blinds, heaters and power points.

Keep medication, string, elastic, small toys or small items such as money out of reach from any position in the crib.

Be aware that ribbons or lace associated with bedding may entangle the infant.

Remove all parts from packaging and check against the parts list.

Do not discard any packaging until you are sure you have all parts and the pack of fittings.

You will find it easier to assemble the crib if a second adult is available to help you.

Designed for an infant having a maximum weight of 9 kg

Furniture can be dangerous if incorrectly installed. Assembly should be carried out by a competent person.

Keep children clear during assembly as pack contains small parts which may present a choking hazard.

The crib should be placed on a horizontal floor.

Young children should not be allowed to play in the vicinity of the mini crib.

All assembly fittings should always be tightened properly and care should be taken that no screws are loose, because a child could trap parts of the body or clothing (eg. Necklaces, strings, ribbons for dummies etc) which would pose a risk of strangulation.

Ensure that the crib is kept away from strong heat sources such as electrical bar, gas and open fires.

One end of the crib has a mark indicating the height of the mattress.

Do not use crib if any part is broken or missing.

Do not leave anything (toys etc) in the mini crib which could provide a footrest or present a danger of suffocation or strangulation.

Do not use more than one mattress.

The recommended mattress size: 38 x 89 cm.

**CAUTION: RECOMMENDED MATTRESS SIZE. IT IS RECOMMENDED THAT THE MATTRESS USED IN THIS CRIB BE A SNUG FIT AND NOT EXCEED 75 MM IN THICKNESS.**

**WARNING: Always ensure the dropside is in the highest position if you are leaving the child unattended in the crib.**

Check regularly to ensure that all the components are secure.

When your child is able to sit, kneel or to pull itself up, the crib shall not be used anymore for this child.

Ensure the crib is positioned away from any cords on blinds or curtains to avoid risk of entanglement.

To clean use a damp cloth, avoiding the use of strong detergents or abrasives.

## CUSTOMER ENQUIRIES

**Manufacturer:**

SIA Troll Smiltene,  
Rigas street 18,  
Smiltene, LV-4729,  
Latvia  
[www.troll.lv](http://www.troll.lv)

**Australian distributor:**

Danish by Design,  
PO Box 1543 Black Rock VIC 3193.  
[www.danishbydesign.com.au](http://www.danishbydesign.com.au)

## PARTS LIST

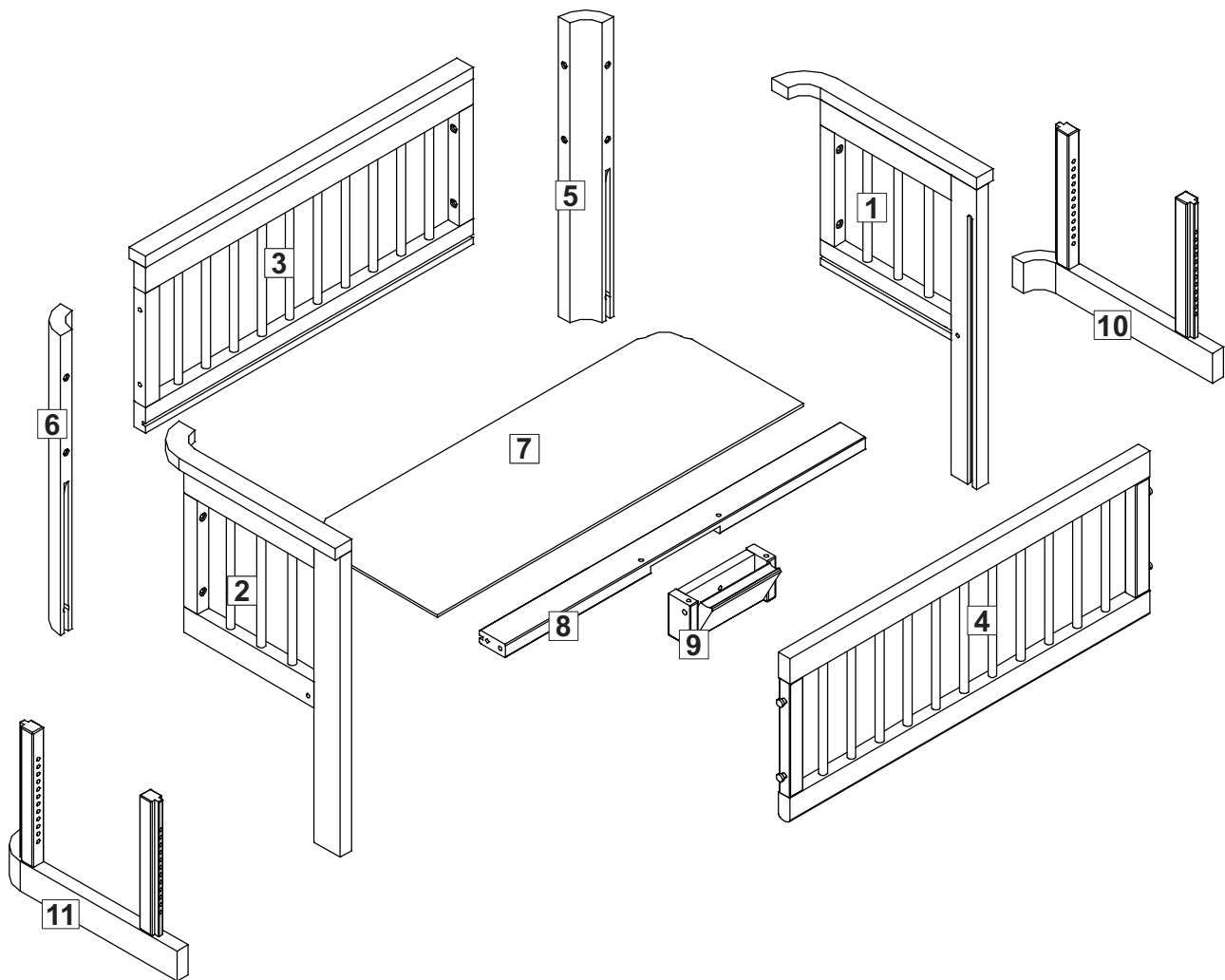

## FITTINGS LIST

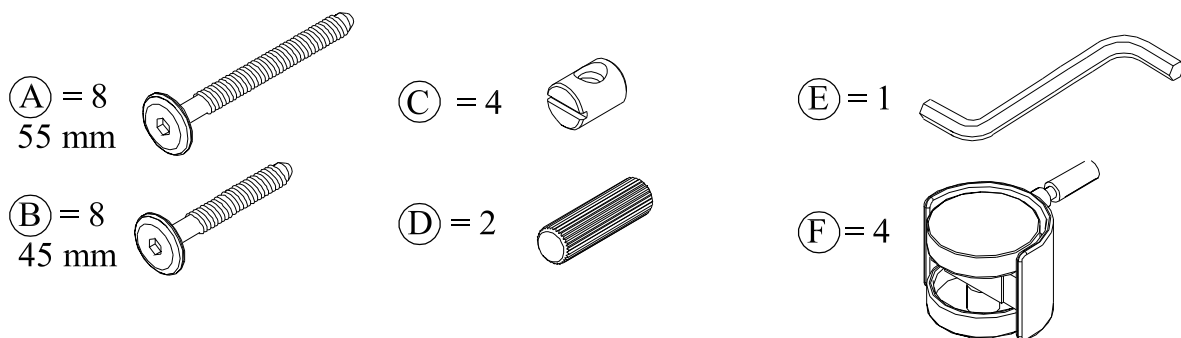

## TOOLS REQUIRED

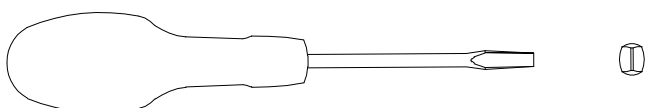

# ASSEMBLING

